

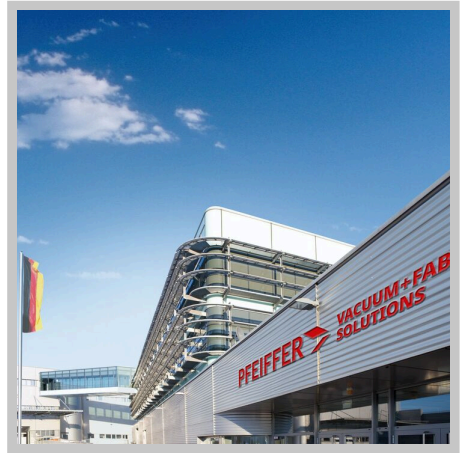

HiPace® 30 Neo with TC 80, DN 63 CF-F



PFEIFFER ➤

HiPace® 30 Neo

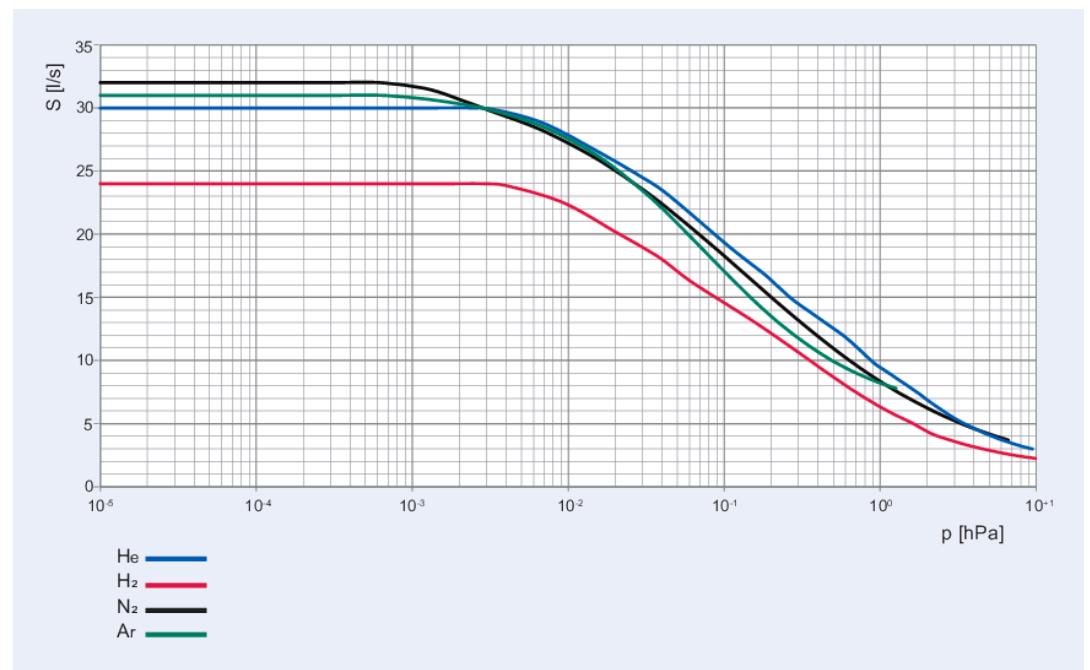

Illustration only

HiPace® 30 Neo with TC 80, DN 63 CF-F

- Small yet powerful turbopump with a pumping speed of up to 32 l/s for N₂
- Highest compression in this pumping speed class
- Simple integration into small analytical systems
- Low weight, ideal for portable applications
- Long maintenance intervals for a long life cycle
- For installation in any orientation
- TC 80 integrated electronic drive unit
- Extensive accessories expand the range of applications

Characteristics



Dimensions

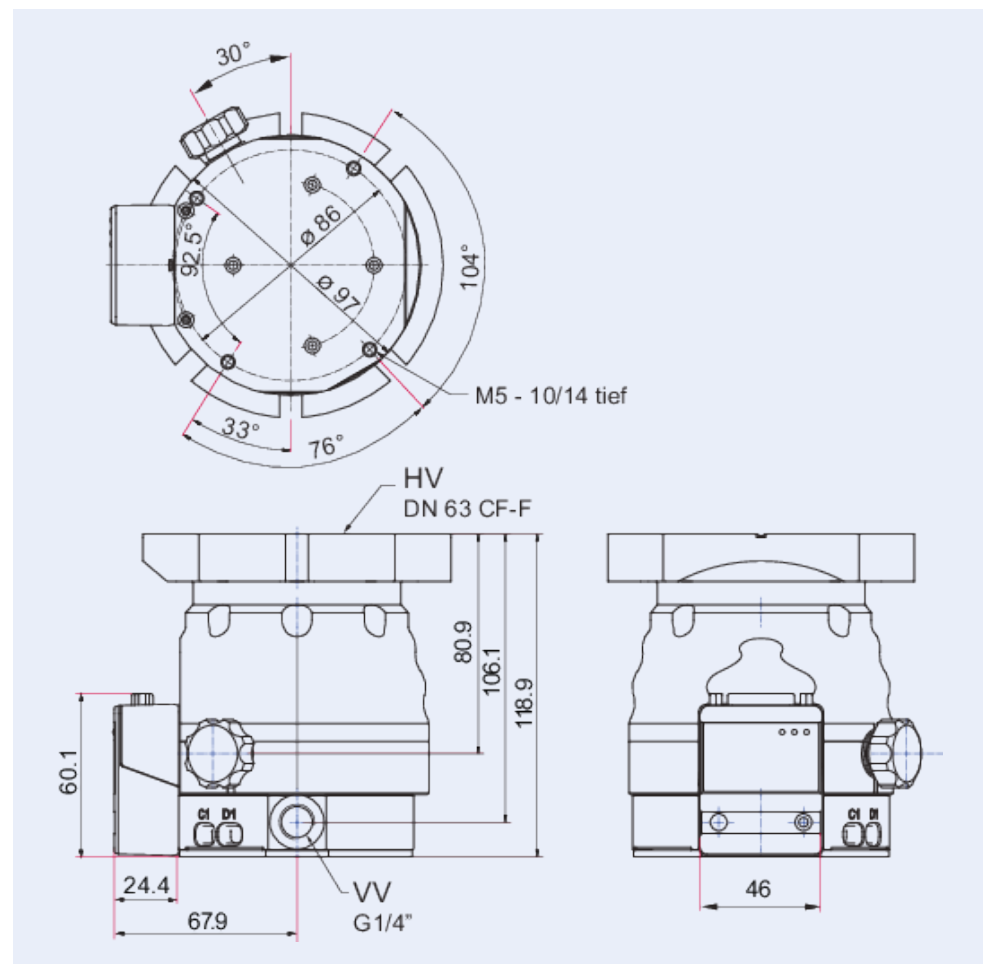

Technical Data	HiPace® 30 Neo with TC 80, DN 63 CF-F
Electronic drive unit	TC 80
Type of electronic drive unit installation	Integrated electronic drive unit
Position of power supply pack	External power supply pack
Cooling method	Natural convection
Pumping speed	72 – 115 m³/h
Pumping speed category	108 m³/h
Rated current consumption	5 A
Vacuum range min	$5 \cdot 10^{-10}$ hPa
Vacuum range max	$5 \cdot 10^{-10}$ hPa
I/O interfaces	RS-485, Remote
Cooling water temperature	5 – 25 °C
Venting connection	G 1/8"
Bearing	Hybrid
Cooling method, optional	Air (forced convection) Water
Mounting orientation	Arbitrary
Input voltage(s)	24 V DC (±10 %)
Emission sound pressure level (EN ISO 2151)	≤48 dB(A)
Permissible axial magnetic field max.	23 mT
Gas throughput at final rotation speed for H ₂	20 hPa·l/s
Gas throughput at final rotation speed for He	7.4 hPa·l/s
Run-up time	65 s
Compression ratio for Ar	$1 \cdot 10^{11}$
Compression ratio for H ₂	$1 \cdot 10^4$
Compression ratio for He	$2 \cdot 10^5$
Compression ratio for N ₂	$1 \cdot 10^{11}$
Gas throughput at final rotation speed for N ₂	3.2 hPa·l/s
Gas throughput at final rotation speed for Ar	0.33 hPa·l/s
Fore-vacuum max. for N ₂	20 hPa 15 Torr 20 mbar
Pumping speed for He	30 l/s
Pumping speed for N ₂	32 l/s
Rotation speed ±2 %	90,000 rpm 90,000 min ⁻¹
Weight	2.9 kg 6.39 lb
Pumping speed for Ar	31 l/s
Pumping speed for H ₂	24 l/s
Permissible radial magnetic field max.	5 mT
Cooling water flow	75 l/h
Power consumption max.	110 W
03 Vacuum range	High Vacuum Ultra-high Vacuum
Connection flange	DN 63 CF-F / G 1/4" Thread
Rotation speed variable	50 – 100 %
Connection flange (in)	DN 63 CF-F

Connection flange (out)	G ¼"
-------------------------	------

Order number	HiPace® 30 Neo with TC 80, DN 63 CF-F
HiPace® 30 Neo with TC 80, DN 63 CF-F	PM P090 316 10



Errors and/or changes excepted. - 2/20/2025

Are you looking for an optimum vacuum solution?

Talk to us:

Pfeiffer Vacuum GmbH

Germany

T +49 6441 802-0

Or scan the barcode, to visit our web page:



<https://webportal.pfeiffer-vacuum.com/global/en/contact>

Follow Us On Social Media

#pfeiffervacuum



www.pfeiffer-vacuum.com

PFEIFFER 